

VARIATORI MONOFASE / ONE-PHASE VARIABLE

Specifiche tecniche / Technical specifications

TENSIONE D'INGRESSO / INPUT VOLTAGE 230V							
Tensione d'uscita / Output voltage 0-230V			Tensione d'uscita / Output voltage 0-260V			Peso Weight (Kg)	Modello Model
Tipo / Type	I (A)	P (VA)	Tipo / Type	I (A)	P (VA)		
HSG 230/1	1,0	230	HSG 260/0,8	0,8	208	1,4	M15
HSG 230/1,6	1,6	368	HSG 260/1,2	1,2	312	2,4	M30 o M30/C
HSG 230/2	2,0	460	HSG 260/1,4	1,4	364		
HSG 230/3	3,0	690	HSG 260/2,5	2,5	650	3,5	M50
HSG 230/4,5	4,5	1035	HSG 260/3,5	3,5	910	4,6	M100
HSG 230/6	6,0	1380	HSG 260/4,5	4,5	1170		
HSG 230/8	8,0	1840	HSG 260/6,3	6,3	1638	7,0	M200
HSG 230/10	10,0	2300	HSG 260/8	8,0	2080		
HSG 230/12	12,0	2760	HSG 260/10	10,0	2600	9,2	M250
HSG 230/18	18,0	4140	HSG 260/15	15,0	3900	13,3	M300
HSG 230/23	23,0	5290	HSG 260/20	20,0	5200	14,0	M400
HSG 230/32	32,0	7360	HSG 260/30	30,0	7800	20,5	M500

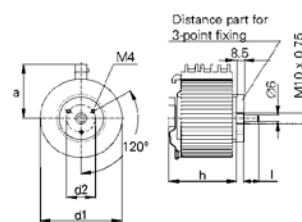

Disegno / Drawing 1

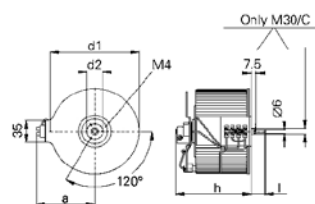

Disegno / Drawing 2

Dimensioni / Dimensions

Modello / Model	a	d1	d2	h	l	Disegno Drawing
M15	52	85	26	70	20	1
M30	74	100	26	100	20	2
M30/C	74	100	-	100	27,5	2
M50	83	119	26	100	20	2
M100	86	125	80-95-100	121	30	3
M200	100	153	80-95-100	121	30	3
M250	110	174	80-95-100	121	30	3
M300	149	226	100	117	52	3
M400	155	300	160	120	52	4
M500	175	340	160	135	52	4

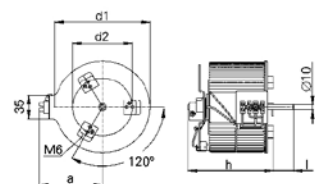

Disegno / Drawing 3

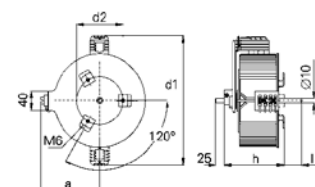

Disegno / Drawing 4

Quadranti / Scales

Tipo / Type	U output (V)	Dimensioni Ø Dimensions Ø
84	0-48	84 mm
84	0-230	84 mm
84	0-260	84 mm
84	0-400	84 mm
84	0-450	84 mm
84	0-100%	84 mm
120	0-230	120 mm
120	0-260	120 mm
120	0-400	120 mm
120	0-450	120 mm
120	0-100%	120 mm

Manopole / Knobs

Tipo / Type	Per modello For model	Dimensioni Ø Dimensions Ø
45	M15	45x22 mm
45	M30	45x22 mm
45	M50	45x22 mm
80	M100	80x23,5 mm
80	M200	80x23,5 mm
80	M205	80x23,5 mm
80	M300	80x23,5 mm
80	M400	80x23,5 mm
80	M500	80x23,5 mm

